

**CONTACT INFORMATION**

Production Director.....Brian Anstedt.....515-246-2331.....banstedt@civiccenter.org  
 Head Carpenter.....Nicholas Romano.....515-246-2332.....nromano@civiccenter.org  
 Head Electrician.....Al Dyer.....515-246-2333.....adyer@civiccenter.org  
 Head Audio/Asst. Production Mgr.....Greg Tracy.....515-246-2334.....gtracy@civiccenter.org  
 I.A.T.S.E. Local 67.....Ryan Anderson, Business Agent.....515-707-8567  
 A.F. of M. Local 75.....Harold Jansen, Contractor.....515-279-1843

**CIVIC CENTER MAILING ADDRESS**

Civic Center of Greater Des Moines  
 221 Walnut St.  
 Des Moines, IA. 50309

**CIVIC CENTER WEB SITE**

[www.civiccenter.org](http://www.civiccenter.org)

**DES MOINES AREA MAP**

<http://map.mapnetwork.com/destination/desmoines/metro/>

**DOWNTOWN DES MOINES MAP**

<http://map.mapnetwork.com/destination/desmoines/>

**DES MOINES INFORMATION**

[www.seedesmoines.com](http://www.seedesmoines.com)

**CIVIC CENTER LOCATION**

The Civic Center of Greater Des Moines is located between Locust St. and Walnut St. and 2<sup>nd</sup> Ave. and 3<sup>rd</sup> St.  
 The loading docks are located on the north side of the building.

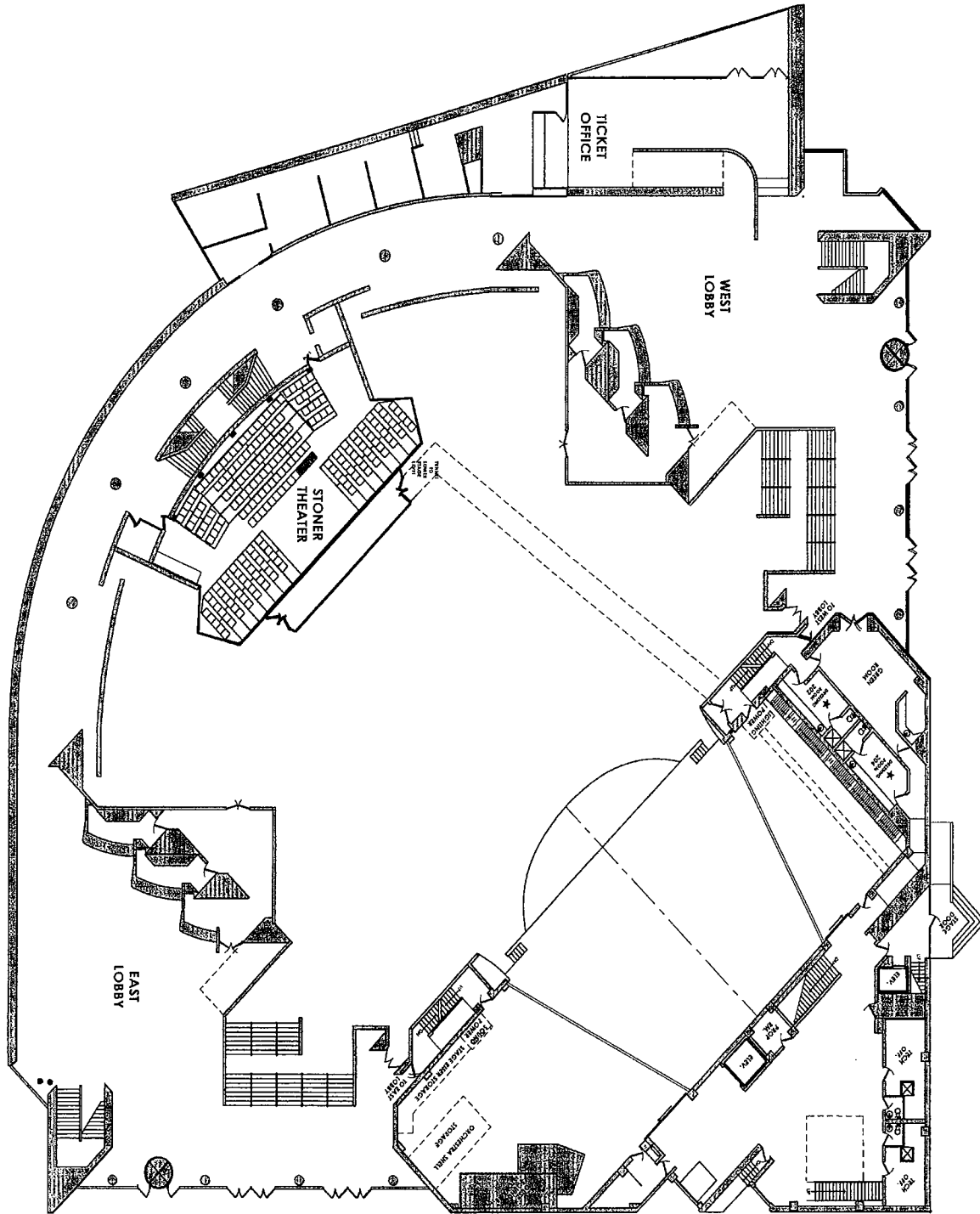

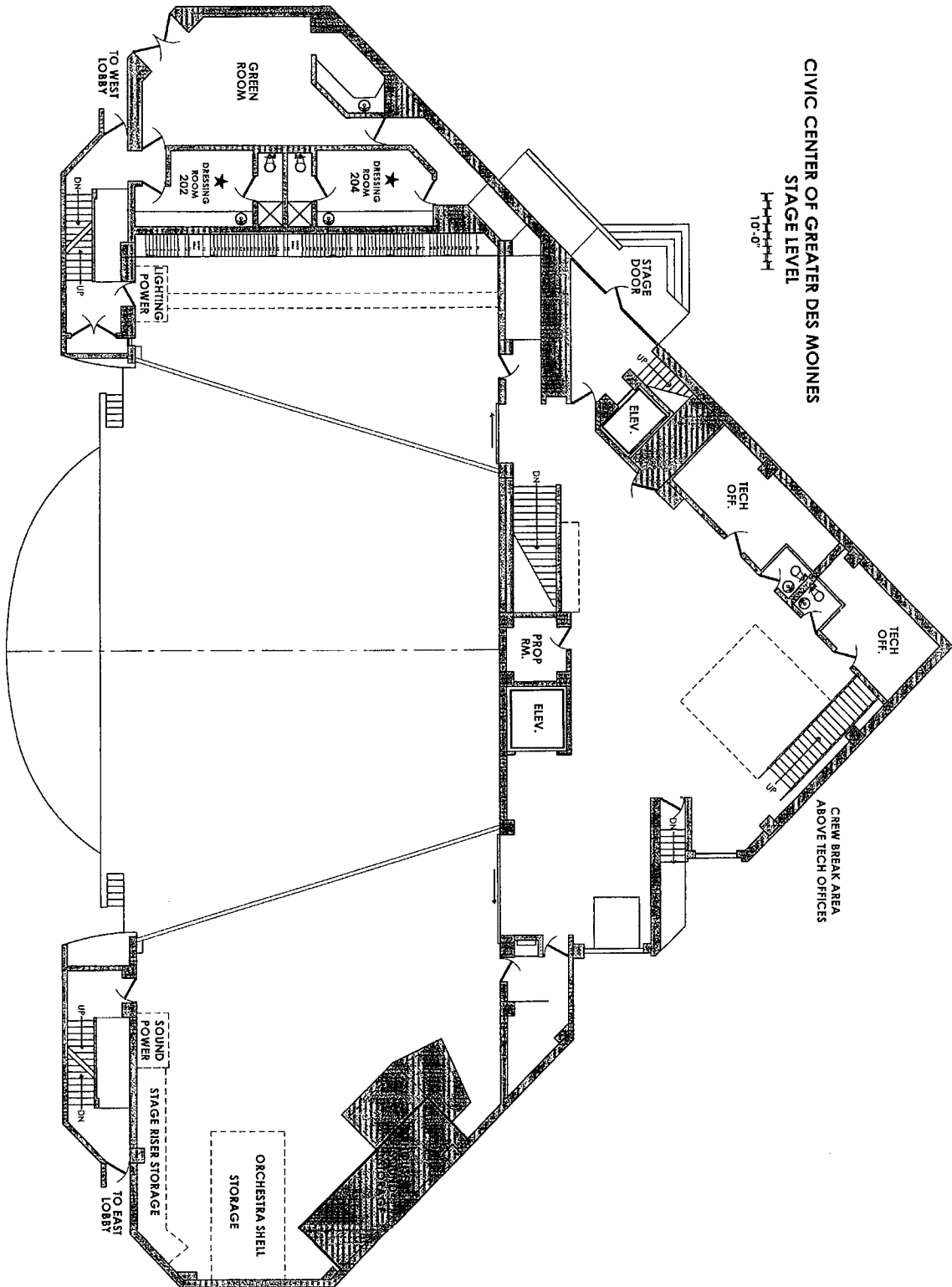

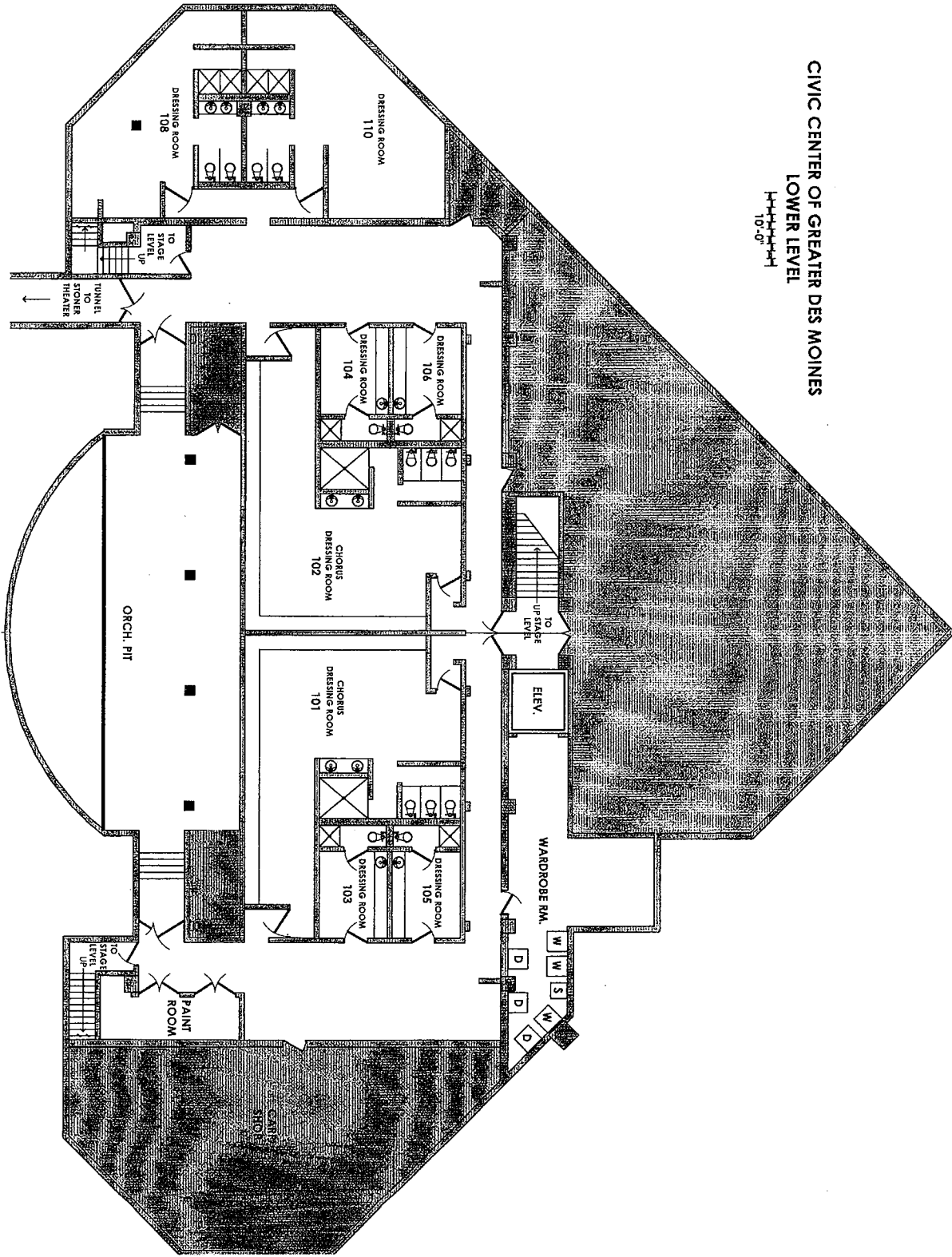

CIVIC CENTER OF GREATER DES MOINES  
LOWER LEVEL  
10-0

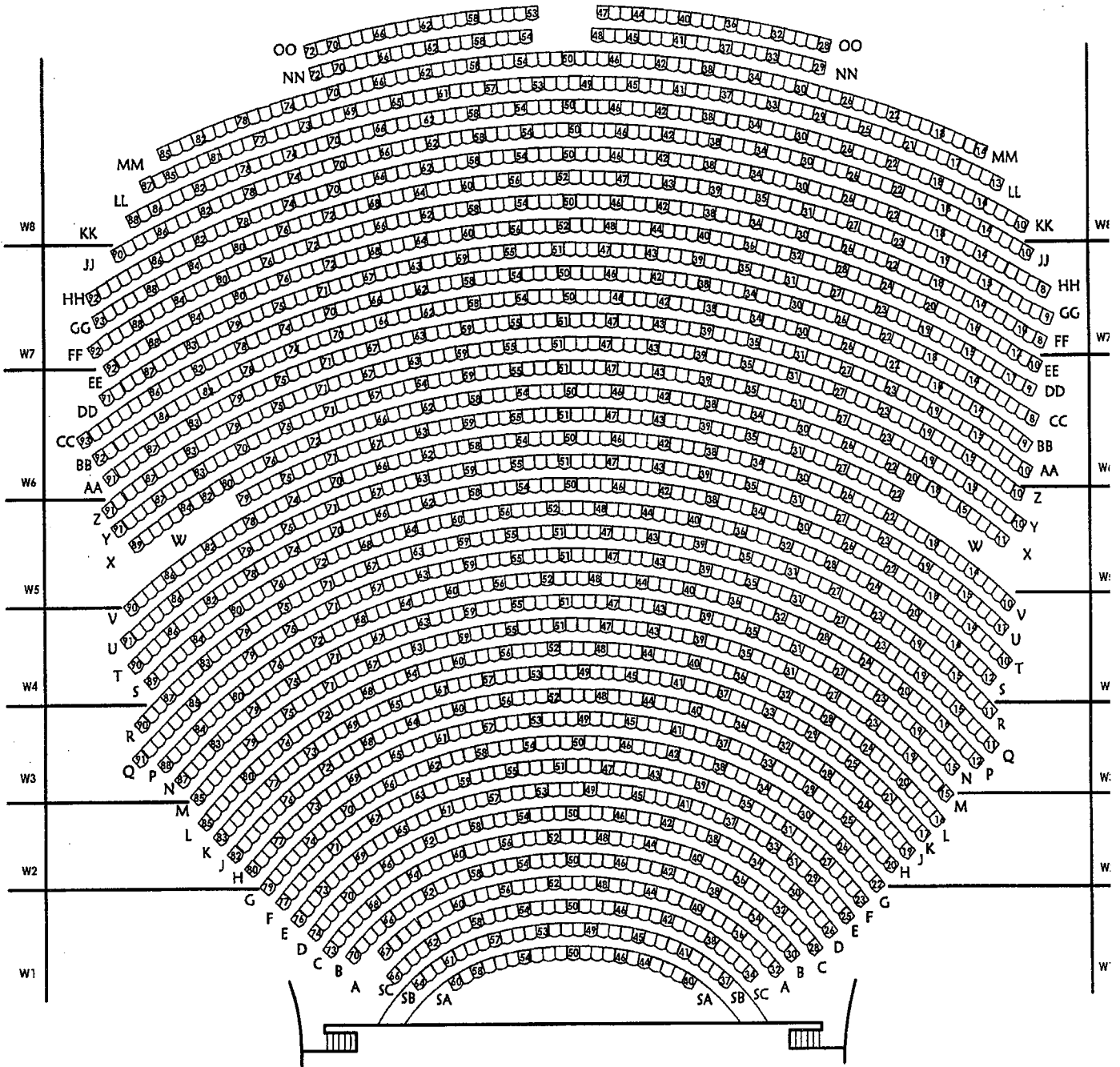

**STAGE AREA**

**LOADING DOCKS**

There are two loading docks located backstage (upstage left) located on Locust St between 2<sup>nd</sup> Ave. and 3<sup>rd</sup> St.

Main dock	Height.....	9'-5½"
	Width.....	7'-11½"
Second dock	Height.....	8'-6"
	Width.....	5'-9"

The docks are at proper trailer height and the main dock is equipped with a leveler. Dock level is the same as stage level.

**SCENERY DOORS**

There are two scenery doors that provide access to the stage from the loading dock area. The doors are located upstage on the back wall. When closed, the scenery doors enable the stage to be acoustically sealed-off from the loading dock and backstage areas.

Stage Left	Height.....	30'-6"
	Width.....	13'-6"
Stage Right	Height.....	12'-4"
	Width.....	8'-9"

**STAGE DIMENSIONS**

Proscenium Width .....	76'-0"
Proscenium Height .....	28'-0"
Centerline to Stage Right Fly Rail.....	53'-0"
(fly rail extends 3'-6 from SR wall)	
Centerline to Stage Left wall.....	85'-0"
Apron Lip to Back (Upstage) wall .....	55'-0"
(apron is straight - runs parallel to curtain line)	
House Curtain Line to Upstage wall.....	49'-0"
House Curtain Line to Apron lip.....	6'-0"
Height of stage floor from house floor.....	3'-5¾"

**STAGE FLOOR**

The stage floor is wood composed of two layers of multi-fiber medium density fiber board laid on top of Neoprene 1" pads. Each layer of the fiber board floor has been laid with staggered joints to the other which reinforces the floor.

There are no stage traps or elevators in the stage floor.

The color of the stage floor is a very dark gray almost black.

**ORCHESTRA PIT**

The orchestra pit consists of an inner and outer lift run by a spiral lift and can move from stage level down to the pit level of 8'-8". The inner pit alone will hold 20 musicians and both pits together will hold 50 musicians.

**CARPENTRY**

**COUNTERWEIGHT SYSTEM**

The counterweight system is a single purchase system. The system, new in the summer of 2006, has a 1,500 lb. per line set capacity and includes schedule 80 pipes.

**GRID**

Grid height above stage floor..... 70'  
 Height above grid to roof..... 8'  
 Access to grid is by ladder from either stage right or stage left hemp gallery bridges.  
 Grid is composed of steel grating on I-beams.  
 There is a hatch up stage right with a 1-ton motor for lifting to the grid or unstacking road boxes.

**HEMP GALLERIES**

**Stage Right**

Distance from Centerline to gallery bridge ..... 43'-6"  
 Height of gallery bridge from stage floor ..... 28'-6"  
 Height of gallery pin rail from stage floor..... 35'-0"  
 Gallery bridge extends 12'-6 from stage right wall

**Stage Left**

Distance from Centerline to gallery bridge ..... 43'-6"  
 Height of gallery bridge from stage floor ..... 46'-5"  
 Height of gallery pin rail from stage floor..... 51'-1"  
 Gallery bridge extends 4'-6 from stage left wall

**LOADING BRIDGE**

Counterweight loading bridge is located stage right.  
 Height of loading bridge from stage floor..... 62'-0"  
 Loading bridge extends 8'-6 from stage right wall.  
 Counterweight available for show use on loading bridge is approximately 30,000 pounds.

**CURTAIN INFORMATION**

**Main House Curtain**

The main house curtain works immediately upstage of the proscenium and fire curtain. The curtain is 81' wide x 32' tall. The curtain is a **guillotine type only** and is manually operated. It does not have center split nor can it be opened on the side. It is a beige cotton velour with 100% fullness. The curtain is mounted on a frame and cannot be removed from the line set.

All masking curtains are made of Saluda black cotton velour with no fullness. They have been flame proofed and certificates of inspection are on file.

**Masking Borders**

- (6) 60' wide x 12' tall. Pipe hem in bottom.
- (1) 80' wide x 12' tall. Pipe hem in bottom.

**Masking Legs**

- (6 pair) 18' wide x 32' tall. Pipe hem in bottom.

**Blackout Curtains**

- (1) 60' wide x 32' tall. Pipe hem in bottom.
- (2) 30' wide x 32' tall. Pipe hem in bottom.
- (1) 80' wide x 32' tall. Sewn chain hem in bottom.
- (1) 60' wide x 32' tall. Sewn chain hem in bottom.

**Curtain Information continued**

**Scrim Curtains**

- (1) White sharkstooth scrim 66' wide x 28' tall. Pipe hem in bottom.
- (1) Black sharkstooth scrim 66' wide x 28' tall. Pipe hem in bottom.
- (1) White Leno Cyc 70' wide x 30' tall. Pipe hem in bottom.

**Movie Screen**

- (1) One projection movie screen 40' wide x 30' tall. Material type: "Twin white" seamless RoscoScreen. Pipe hem in bottom. This screen can be utilized for both front and rear projection.

**HANGING PLOT**

Set #	Distance From Proscenium	Distance From Curt Line	Distance From Show 0'-0"	Batten Length	Civic Center House Stock	Show/Production Stock
P	0'-0	(1'-6)			Proscenium	<b>Proscenium</b>
A	0'-6	(1'-0)			Fire Curtain	<b>Fire Curtain</b>
A	1'-0	(0'-6)			Fire Curtain	<b>Fire Curtain</b>
1	1'-6	0'-0		86'	<u>House Main Curtain</u>	<b>House Main Curtain</b>
2	2'-0	0'-6		86'	<u>#1 Border</u>	
3	2'-6	1'-0		86'	<u>#1 Legs</u>	
4	3'-0	1'-6		66'	available set	
5	3'-6	2'-0		66'	available set	
6	4'-0	2'-6		66'	available set	
7	4'-6	3'-0		66'	available set	
8	5'-0	3'-6		66'	available set	
9	5'-6	4'-0		66'	available set	
10	6'-0	4'-6		66'	available set	
11	6'-6	5'-0		66'	available set	
12	7'-0	5'-6		66'	available set	
13	7'-6	6'-0		66'	available set	
14	8'-0	6'-6		FIXED	<u>Orch Ceiling Trip</u>	<b>NOT AVAILABLE</b>
	8'-6	7'-0		FIXED	<u>#1 Orchestra Ceiling</u>	<b>NOT AVAILABLE</b>
	9'-0	7'-6			<u>Orch Ceiling Overlap</u>	<b>NOT AVAILABLE</b>
17	9'-6	8'-0		66'	available set	
	10'-0	8'-6			Outrigger Bracket	<b>NOT AVAILABLE</b>
19	10'-6	9'-0		66'	<u>#2 Border</u>	
20	11'-0	9'-6		86'	<u>#2 Legs</u>	
21	11'-6	10'-0		66'	available set	
22	12'-0	10'-6		66'	available set	
23	12'-6	11'-0		66'	available set	
24	13'-0	11'-6		66'	available set	
25	13'-6	12'-0		66'	available set	
26	14'-0	12'-6		66'	available set	
27	14'-6	13'-0		66'	available set	
28	15'-0	13'-6		66'	available set	
29	15'-6	14'-0		66'	available set	
30	16'-0	14'-6		66'	available set	
31	16'-6	15'-0		66'	available set	
32	17'-0	15'-6		66'	available set	
33	17'-6	16'-0		66'	available set	
34	18'-0	16'-6		66'	available set	
35	18'-6	17'-0		66'	<u>#3 Border</u>	
36	19'-0	17'-6		86'	<u>#3 Legs</u>	
37	19'-6	18'-0		66'	available set	
	20'-0	18'-6			Outrigger Bracket	<b>NOT AVAILABLE</b>